

GM17 Thin Sheet Nutsert

Aluminium · Low profile · Round · Open end
M4 - M8

Features

- Designed to provide load bearing threads in thin sheet materials
- Low profile head allows near flush fit to application

Material

- Aluminium alloy 5052 (2.5% Mg), natural

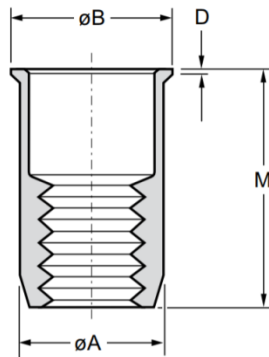

Before Placement

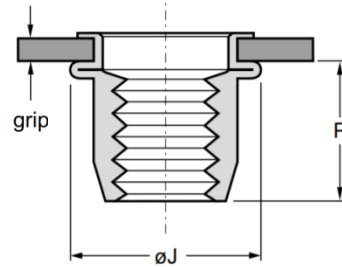

After Placement

Part No.	Thread Size	Grip Range		Hole Size	øA	øB	D	øJ	M	P
		min.	max.	+0.1/-0	max.	+0.3/-0.2	+0.3/-0.1	max.	±0.35	max.
0GM17-00430	M4 x 0.7	0.50	3.00	6.10	6.00	6.50	0.50	8.10	10.75	6.80
0GM17-00530	M5 x 0.8	0.50	3.00	7.10	7.00	7.50	0.50	9.60	12.00	8.30
0GM17-00630	M6 x 1.0	0.50	3.00	9.10	9.00	9.50	0.50	12.10	14.50	10.00
0GM17-00830	M8 x 1.25	0.50	3.00	11.10	11.00	11.50	0.50	14.50	16.00	11.50

Thread Size	Max. torque	Pull-out	Torque-to-turn	Push-out
	Nm max.	kN	Nm min.	kN
M4 x 0.7	4.0	3.7	1.6	0.7
M5 x 0.8	5.3	5.4	2.1	0.8
M6 x 1.0	10.8	8.5	2.4	0.9
M8 x 1.25	23.0	13.1	5.4	1.0



Can't find what you are looking for?

We can provide unique and customized solutions.
Contact your nearest [Gripwell](#) team for assistance!